



ST 1308

Supreme Tweeter,
 Ø 130mm, 8Ω
 offset dome



Features:

- * Underhung voice coil
- * Large Hexatech™ aluminum voice coil
- * 130 mm offset dome aluminum face plate
- * Replaceable Acuflex™ dome / coil assembly
- * Neodymium flat pancake design magnet
- * High power handling

SPECIFICATIONS

General Data	
Overall Dimensions	DxH 130 mm (5.12") x 40mm (1.57")
Nominal Power Handling (DIN)	P 220W/12dB
Transient Power 10ms	1000W
Sensitivity 2.83V/1M	91.5dB SPL
Frequency Response	See graph
Dome Material	Acuflex™ hand coated soft dome
Net Weight	Kg 0.52

Electrical Data	
Nominal Impedance	Z 8Ω
DC Resistance	Re 5.2Ω
Voice Coil Inductance @ 1KHz	LBM 0.09mH

Voice Coil and Magnet Parameters	
Voice Coil Diameter	DIA 28mm
Voice Coil Height	2.7mm
HE Magnetic Gap Height	HE 4.2mm
Max. Linear Excursion	X
Voice Coil Former	Aluminum
Voice Coil Wire	Hexatech™ Aluminum
Number Of Layers	2
Magnet System Type	Neodymium Flat Pancake
B Flux Density	B 1.8 T
BL Product	BXL

T-S Parameters	
Suspension Compliance	Cms
Mechanical Q Factor	Qms
Electrical Q Factor	Qes
Total Q Factor	Qts
Mechanical Resistance	Rms
Moving Mass	Mms 0.44 g
Eq. Cas Air Load (liters)	VAS
Resonant Frequency	Fs 680 Hz ±10%
Effective Piston Area	SD 6.0 cm ²

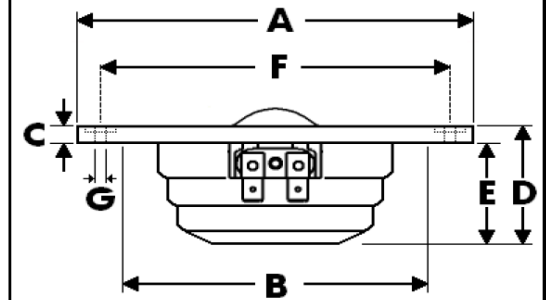
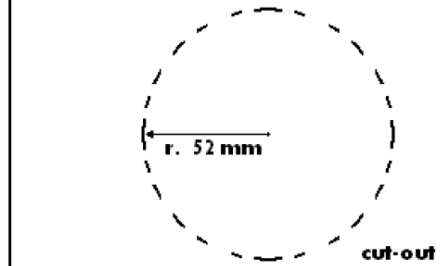

- A** - Overall diameter 130mm
- B** - Cut out diameter 104mm
- C** - Flange thickness 5mm
- D** - Overall height 40mm
- E** - Magnet/Chamber depth 35mm
- F** - Mounting holes location diameter 118mm
- G** - 6 Mounting holes, at 60° interval, inner hole diameter Ø 3.7mm, pocket h 1.5mm, Ø 8mm

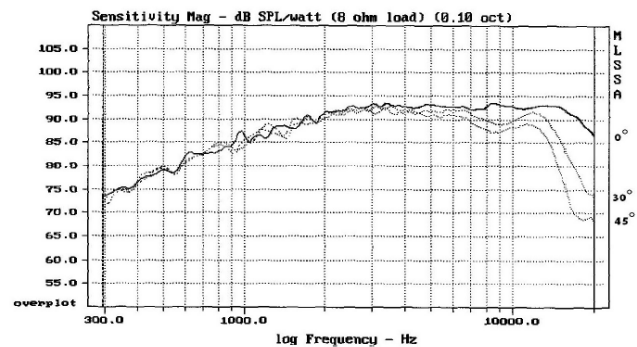
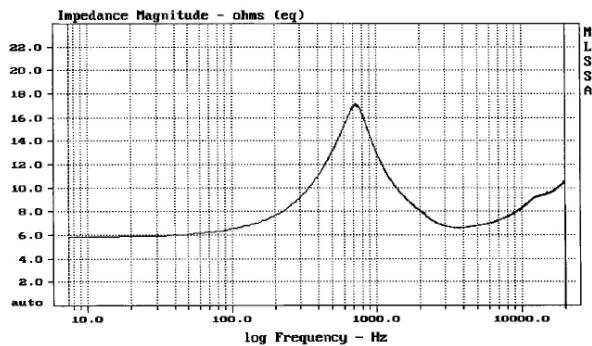

Measured on IEC baffle using Bruel & Kjaer 3144 model microphone.

Morel operate policy of continuous product design improvement, consequently specifications are subject to alteration without prior notice.